

## Warewashing Small Single Skin Glasswasher, drain pump and detergent and rinse aid dispenser, 30b/h

ITEM # \_\_\_\_\_

MODEL # \_\_\_\_\_

NAME # \_\_\_\_\_

SIS # \_\_\_\_\_

AIA # \_\_\_\_\_



402295 (ZSG)

 Glasswasher (small), with  
single skin, built-in drain pump  
and detergent and rinse aid  
dispenser, 1 cycle, 30b/h

### Short Form Specification

#### Item No.

Unit shall be Glasswasher type hot water rinsing using rack dimension of 400\*400mm. Electrical characteristics to be 230 volts single phase 50Hz operation with one wash cycle of 120 seconds. Washing performance is ensured by a powerful wash pump and revolving washing spray arm on bottom. Upper rinsing and lower integrated washing & rinsing arms in composite material. Rinse temperature and pressure guaranteed by built in pressure boiler. Double skinned counter-balance door. Large door opening of 290mm for washing tall glasses. Single skinned cabinet. Welded washing tank with round corners. 304 stainless steel construction to include door & frame. The unit shall include drain pump, detergent and rinse aid dispenser pumps and is equipped with electric cable with Schuko plug.

### Main Features

- Maximum capacity of 30 racks per hour.
- Equipped with single phase electrical cable and Schuko plug for easy and fast installation.
- Easy service access to main components without moving the unit.
- Built-in rinse aid and detergent dispenser with automatic initial and continuous cycle loading for perfect result while minimizing service and maintenance needs.
- Equipped with drain pump for easy and quick installation without opening the machine.
- 120 seconds cycle.
- Built-in pressure boiler designed to raise incoming water to a guaranteed minimum temperature of 82°C for sanitizing rinse. No external boiler is required.
- Washing system endowed with rotating washing arms, high powered wash pump and large capacity wash tank for professional washing.
- Welded wash tank, sloped towards the drain, provides fast drainage in only a few minutes and guarantee a water tight solution.

### Construction

- Completely closed on the back by a cover plate.
- Internal components (arms and filter) are easy extractable.
- Unit to feature rinse aid and detergent dispenser pumps.
- Robust structure thanks to stainless steel construction.

### Sustainability

- Insulated double skin door construction preserves heat inside the tank to lower energy consumption and the noise. Counter-balance mechanism minimizes impact when opening and closing.
- Finished in top quality materials to ensure durability.
- Simple operation control panel.

### Included Accessories

- 1 of Square basket for glasses 400x400x150mm PNC 864470
- 1 of Insert for 12 saucers, 290x90x75mm PNC 867048
- 1 of Square cutlery container, 89x113x113mm PNC 867049

### Optional Accessories

- Square basket for plates, 400x400x110mm PNC 867039 ☐
- Inclination insert for glasses, 400x400mm PNC 867044 ☐
- Round basket for glasses, 400x180mm PNC 867047 ☐
- Inclination insert for glasses 400x400 mm PNC 867069 ☐
- Kit detergent dispenser for single skin XS and single skin S glasswasher PNC 867072 ☐

APPROVAL: \_\_\_\_\_

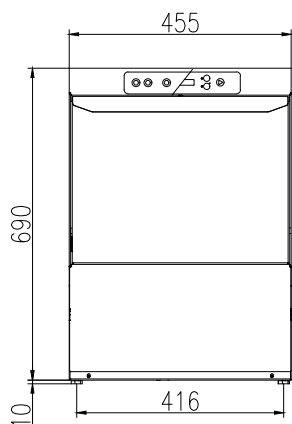
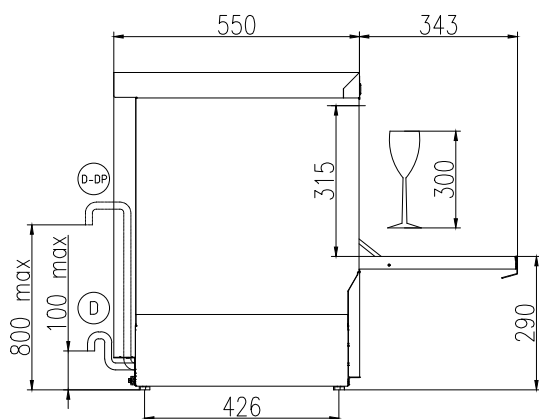
**Front**

**Side**

**CW11** = Cold Water inlet 1  
(cleaning)

**XR** = Rinse aid connection

**D** = Drain

**EI** = Electrical inlet (power)

**EO** = Electrical Outlet

**WI** = Water inlet

**XD** = Detergent connection

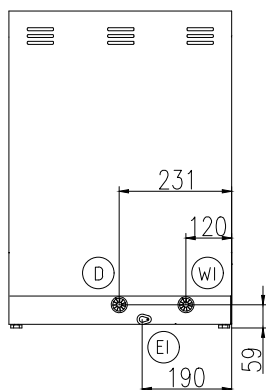
**Rear side**

**Electric**

Supply voltage:

402295 (ZSG) 220-240 V/1 ph/50 Hz

Default Installed Power: 2.7 kW

Boiler heating elements: 2.7 kW

Tank heating elements: 2.4 kW

Wash pump size: 0.2 kW

**Water:**

Pressure, bar min/max: 2-5 bar

Water supply temperature\*: 10-50 °C

Drain line size: 29mm

Washing tank capacity (lt): 12

Water consumption per cycle (lt): / 2

Boiler Capacity (lt): 3

Incoming water line size: 3/4"

**Key Information:**

Baskets per hour (fast\*/glasses\*/  
multipurpose&cups/intensive\*/  
MyEco):

30 / 0 / / /

Working cycles time (sec.):

120 / / / /

Wash temperature: 60°C

Cell dimensions - width: 405 mm

Cell dimensions - depth: 437 mm

Cell dimensions - height: 315 mm

Rinse temperature: 85 °C

External dimensions, Width: 455 mm

External dimensions, Depth: 550 mm

External dimensions, Height: 700 mm

Net weight: 38 kg

Shipping weight: 42 kg

Shipping height: 850 mm

Shipping width: 540 mm

Shipping depth: 630 mm

Shipping volume: 0.29 m³

**Sustainability**

Noise level: 61 dBA